

6

5
10,632 SF

OUTLOT A

ALLISON WAY

15' UTILITY EASEMENT
10' SANITARY SEWER EASEMENT

SETBACKS:

- FRONT 15 FEET
- GARAGE FACE 25 FEET
- SIDE 6 FEET
- REAR 20 FEET

LEGEND:

- EASEMENT
- - - SETBACK
- BUILDABLE WIDTH (AT 10' INTERVALS)

DISCLAIMER:
THIS DOCUMENT AND THE INFORMATION CONTAINED WITHIN, INCLUDING BUT NOT LIMITED TO THE LOT DIMENSIONS, IS FOR REFERENCE ONLY. THE FINAL PLAT, AS RECORDED WITH THE JOHNSON COUNTY RECORDER, SHALL GOVERN IN THE EVENT OF A DISCREPANCY.

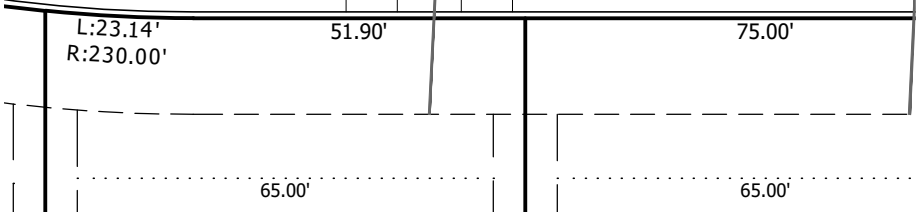

ENGINEER: 	CLIENT: MONUMENT HILLS, LLC	SHEET NAME: LOT 5 LAYOUT	
	PROJECT NAME: MONUMENT HILLS RESIDENTIAL SUBDIVISION IOWA CITY	PROJECT NO: 1026	PROJECT MANAGER: WELCH
	REVISION: --	ISSUED DATE: 04-10-2023	SHEET NUMBER: 5

PLOTTED: 4/11/2023 9:41 PM, PATH: F:\20 Projects\1026\30.dwg, 1026 MonumHills Lot Mapping, © 2022 - WELCH DESIGN AND DEVELOPMENT, LLC